

falmec

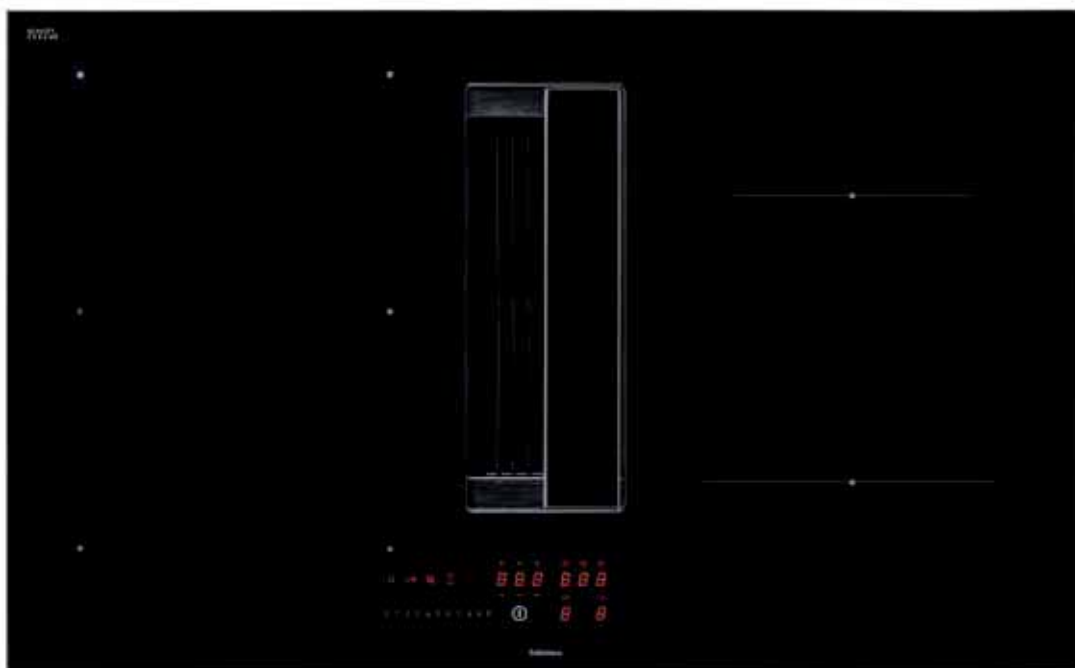

Zero

INSTRUCTIONS BOOKLET

LIBRETTO ISTRUZIONI ^{IT}
INSTRUCTIONS BOOKLET ^{EN}
GEBRAUCHSANWEISUNG ^{DE}
MODE D'EMPLOI ^{FR}
MANUAL DE INSTRUCCIONES ^{ES}

ИНСТРУКЦИИ ^{RU}
INSTRUKCJA OBSŁUGI ^{PL}
BRUGSANIVSNINGER ^{DK}
HANDLEIDING ^{NL}
OHJEKIRJA ^{FI}

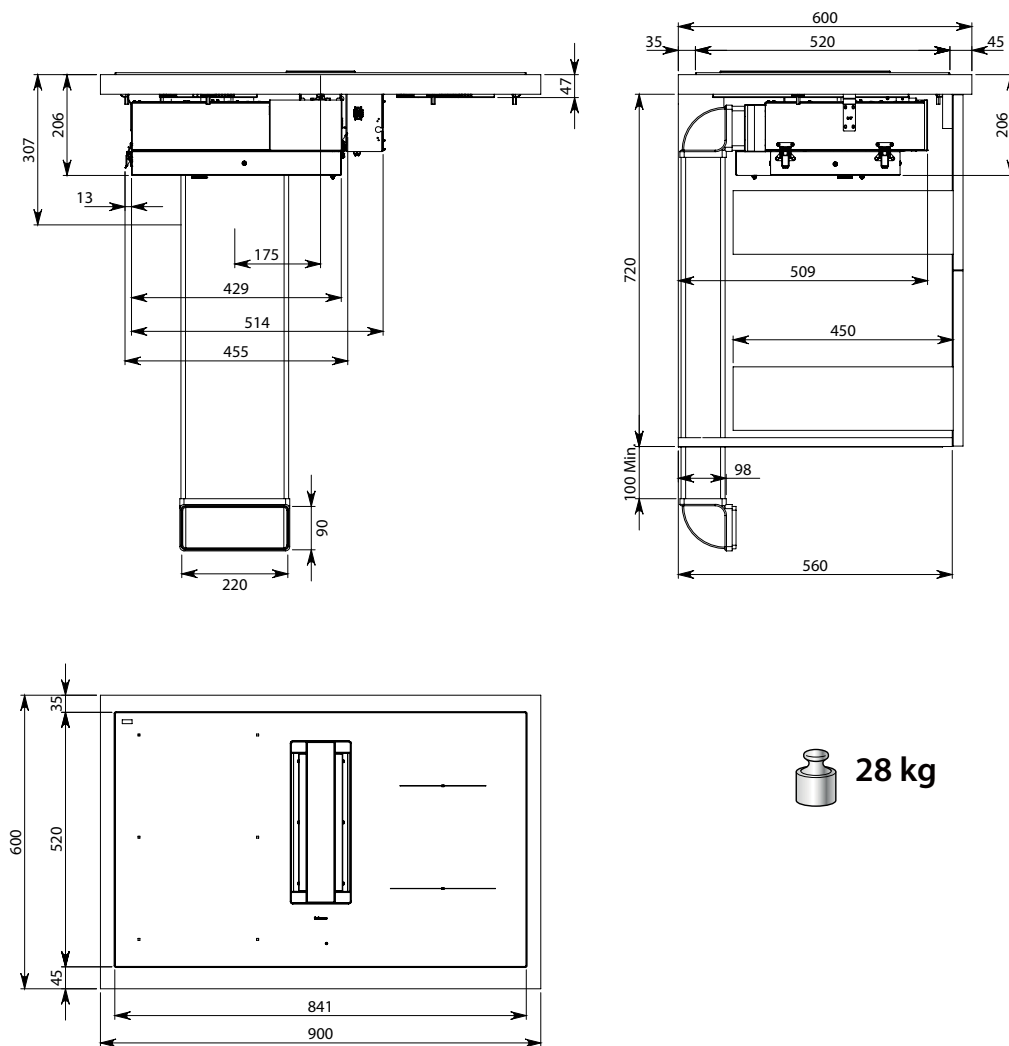

 **28 kg**

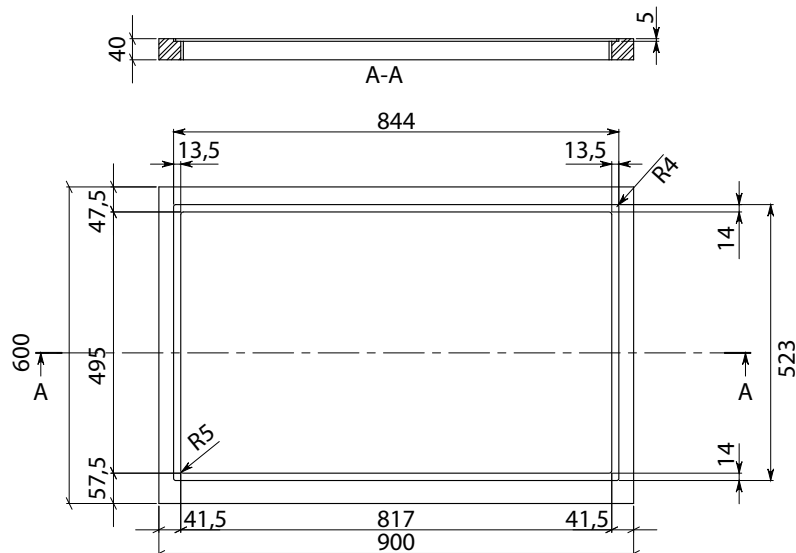

IT - Misure foro per incasso.
 EN - Hole measurements for installation.
 DE - Lochabmessungen für Einbau.
 FR - Mesures du trou pour encastrement.
 ES - Medidas del orificio para empotrado.
 RU - Размеры монтажного отверстия.
 PL - Wymiary otworu do zabudowy.
 DK - Mål til åbning for indbygning.
 NL - Maten gat voor inbouw.
 FI - Aukon mitatukset asennusta varten.

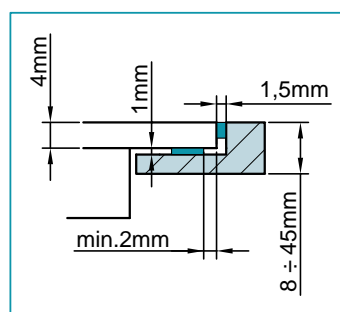
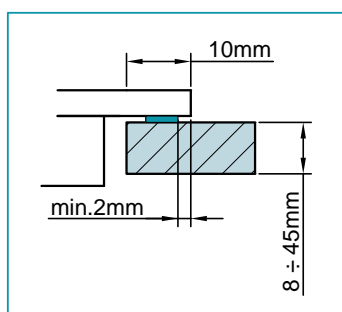

**BUILT-IN
version:**

Wall 90x60

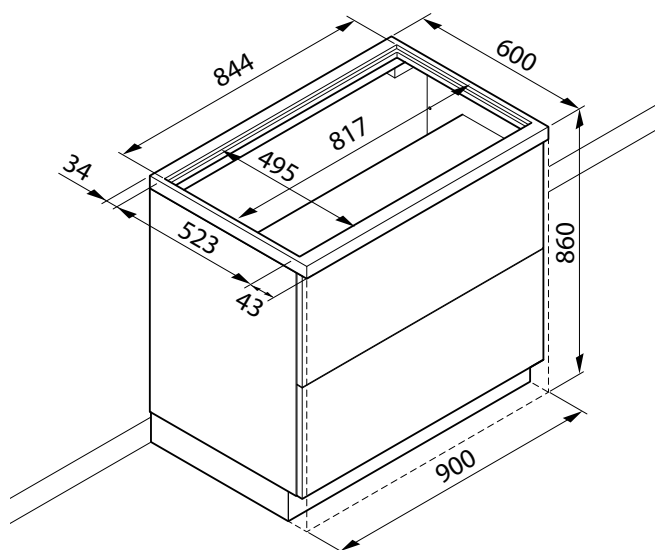
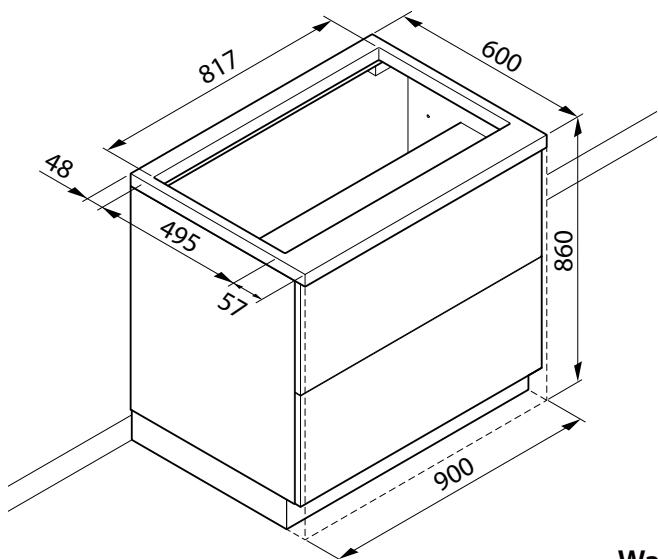

Wall 90x70

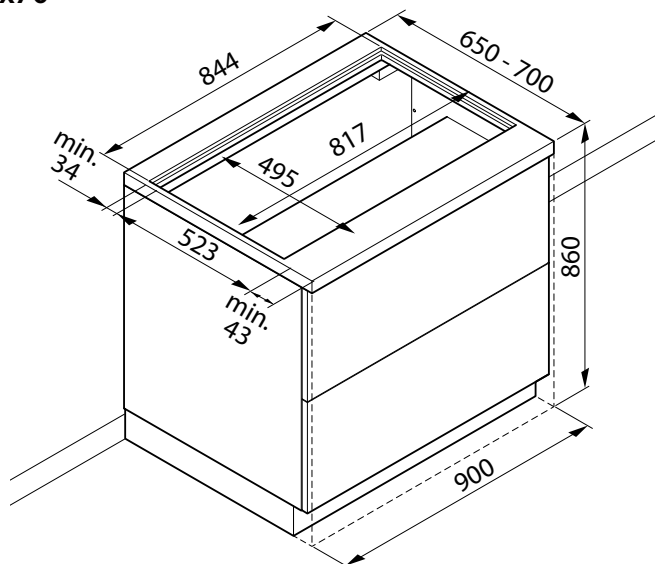
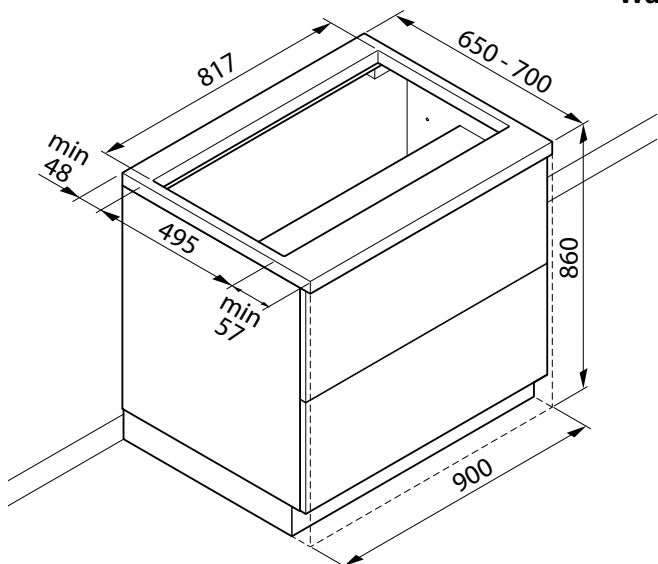

Island 90x90

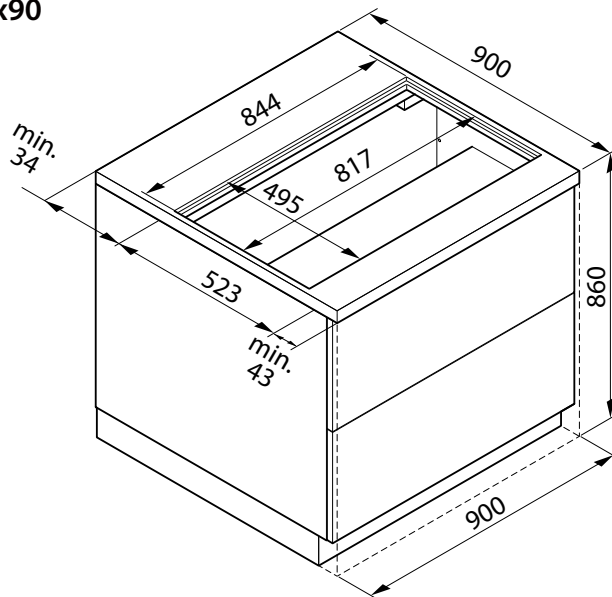
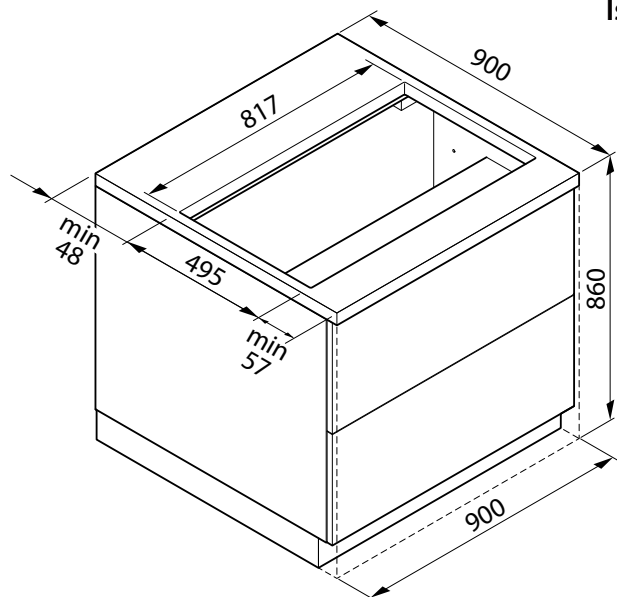

- IT - Distanze di sicurezza (1). Operazioni preliminari: Taglio del top (2). Inserimento cappa su base (3-4).
- EN - Safety distance (1). Preliminary operations: Cutting the top (2). Insertion of the hood onto the base (3-4).
- DE - Sicherheitsabstände (1). Vorbereitende Arbeiten: Schneiden Sie die Spitze (2). Einsetzen der Haube auf der Basis (3-4)
- FR - Distances de sécurité (1). Opérations préliminaires: Couper le haut (2). Insertion de la hotte sur la base (3-4).
- ES - Distancias de seguridad (1). Operaciones preliminares: Cortando la parte superior (2). Inserción de la campana en la base (3-4).
- RU - Безопасное расстояние (1). Предварительные операции: Вырезание верхней части (2). Установка вытяжки на основание (3-4).
- PL - Odległości bezpieczeństwa (1). Operacje wstępne: Cięcie górnej części (2). Umieszczenie okapu na podstawie (3-4).
- DK - Sikkerhedsafstand (1). Indledende handlinger: Skær toppen (2). Isætning af emhætten på underlaget (3-4).
- NL - Veiligheidsafstanden (1). Handelingen vooraf: Snijden van de top (2). Plaatsing afzuigkap op basis (3-4).
- FI - Turvaetäisyys (1). Alustavat toimenpiteet: Tason leikkaaminen (2). Liesituulettimen asentaminen alustaan (3-4).

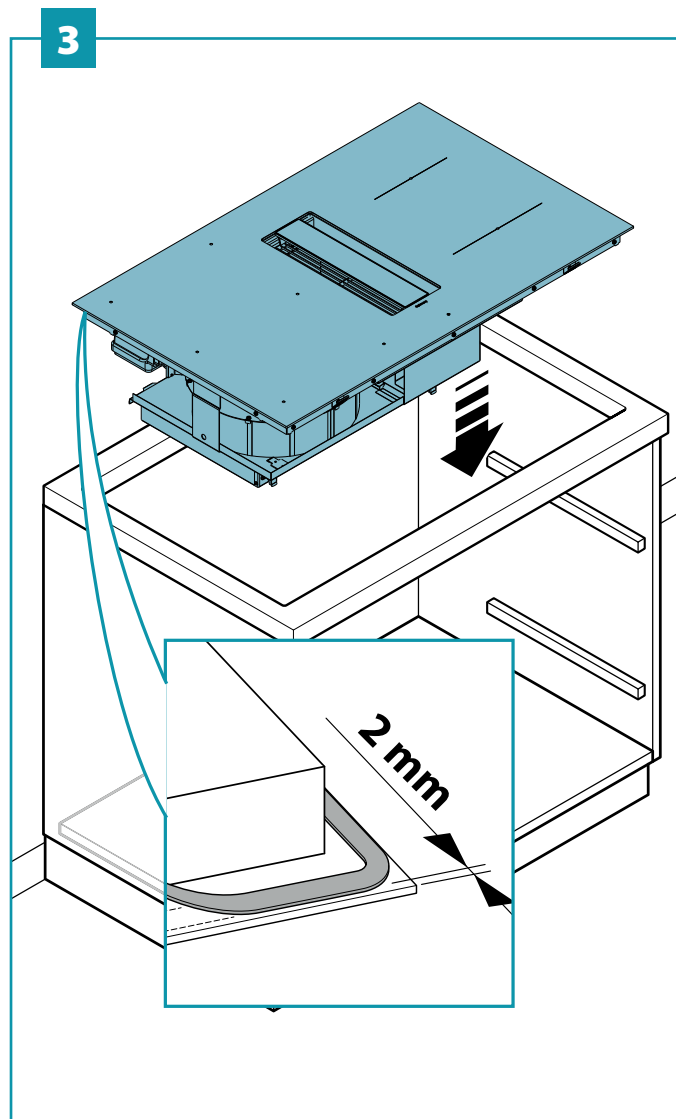
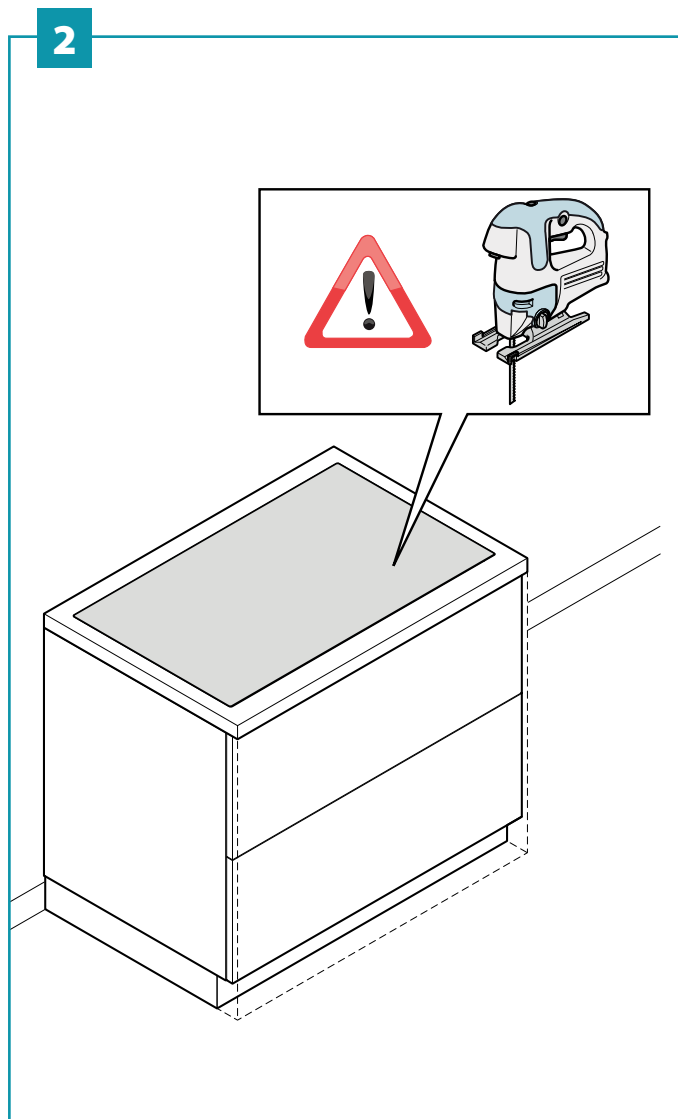
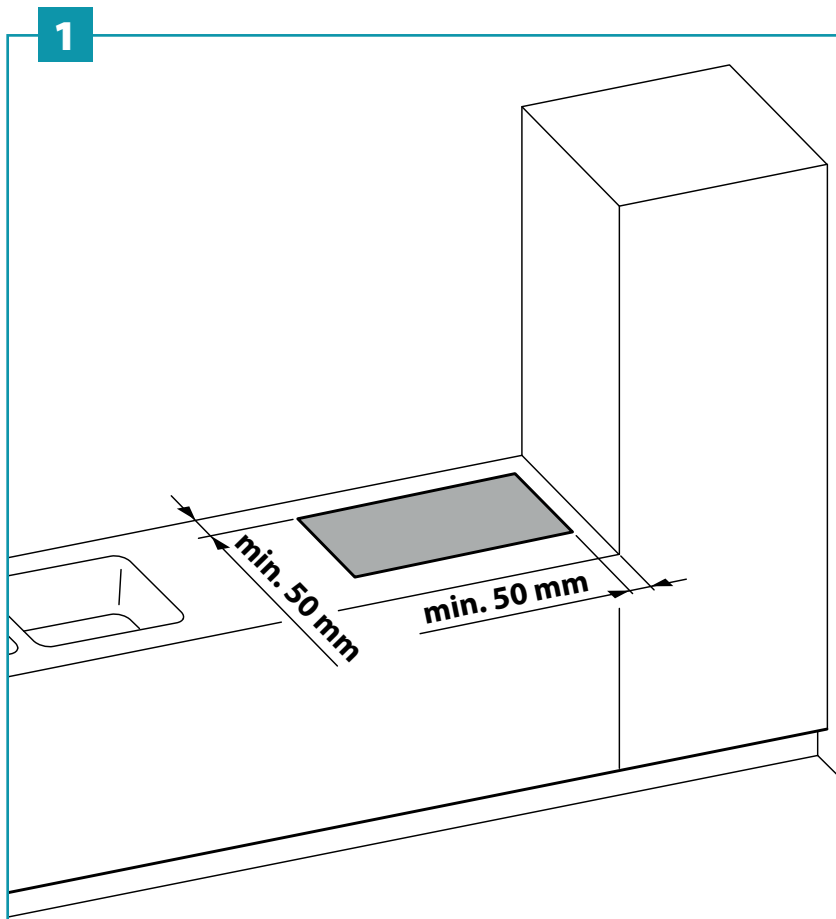

IT - Collegamenti elettrici cappa e piano cottura (5).

EN - Motor and hob electrical connections (5).

DE - Elektrische Anschlüsse des Motors und die Kochfläche (5).

FR - Branchements électriques moteur et plan de cuisson (5).

ES - Conexiones eléctricas del motor y placa de cocción (5).

RU - Электрические подключения двигателя и индукционной поверхности (5).

PL - Połączenia elektryczne silnika i płytę grzewczą (5).

DK - Motorens og pladens elektriske tilslutninger (5).

NL - Elektrische aansluitingen afzuigkap en kookplaat (5).

FI - Moottorin ja lieden sähköliitännät (5).

4

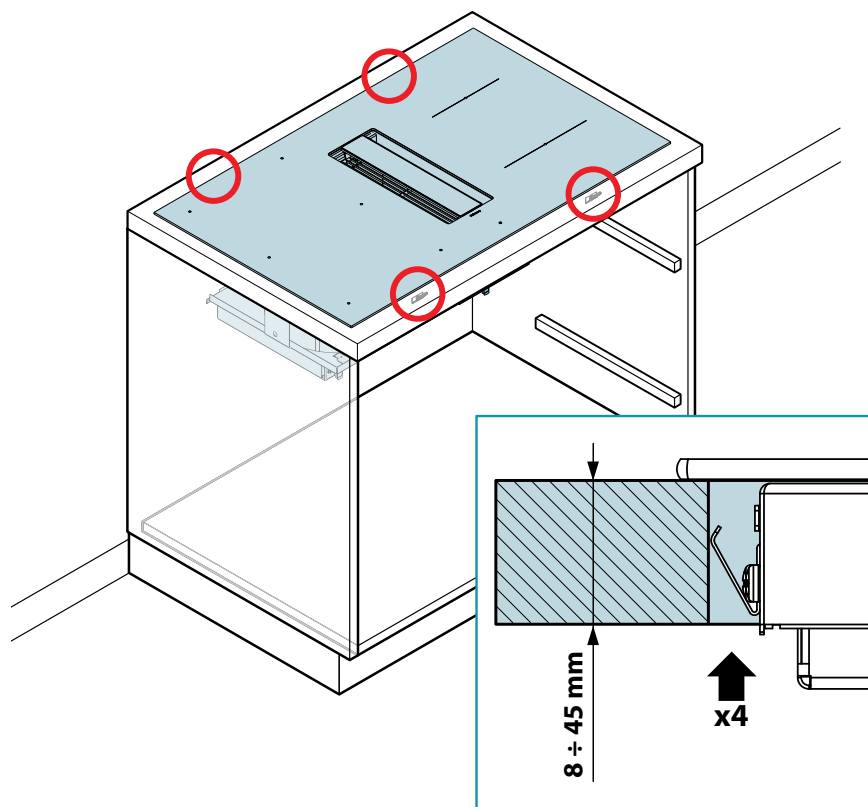

5

① ② ③ ④ ⑤	⏏	1P+N
L N		
① ② ③ ④ ⑤	⏏	2P+N
L1 L2 N		
① ② ③ ④ ⑤	⏏	2P
L1 L2	230V	
① ② ③ ④ ⑤	⏏	3P+N
L1 L2 L3 N		

Max 7400W
220-240V / 380-415V 3N
50-60 Hz

220-240 V

380-415 V 2N

220-240 V 2

380-415 V 3N

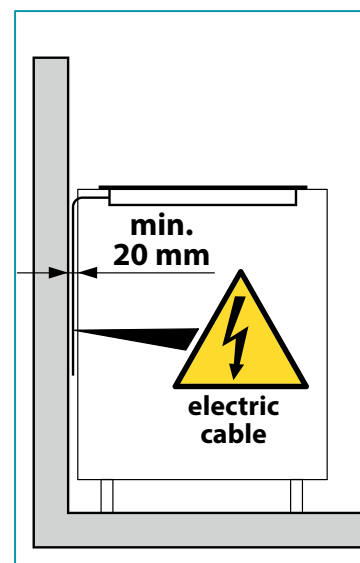
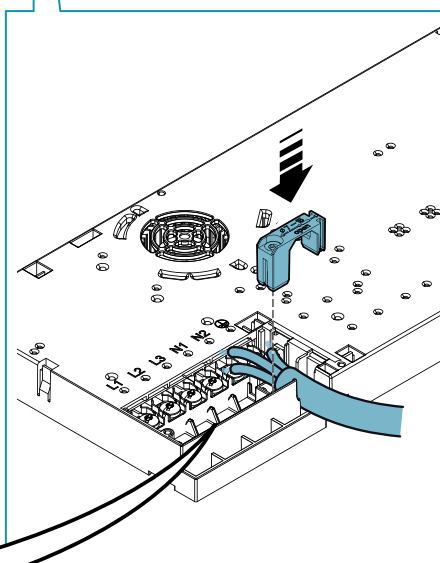

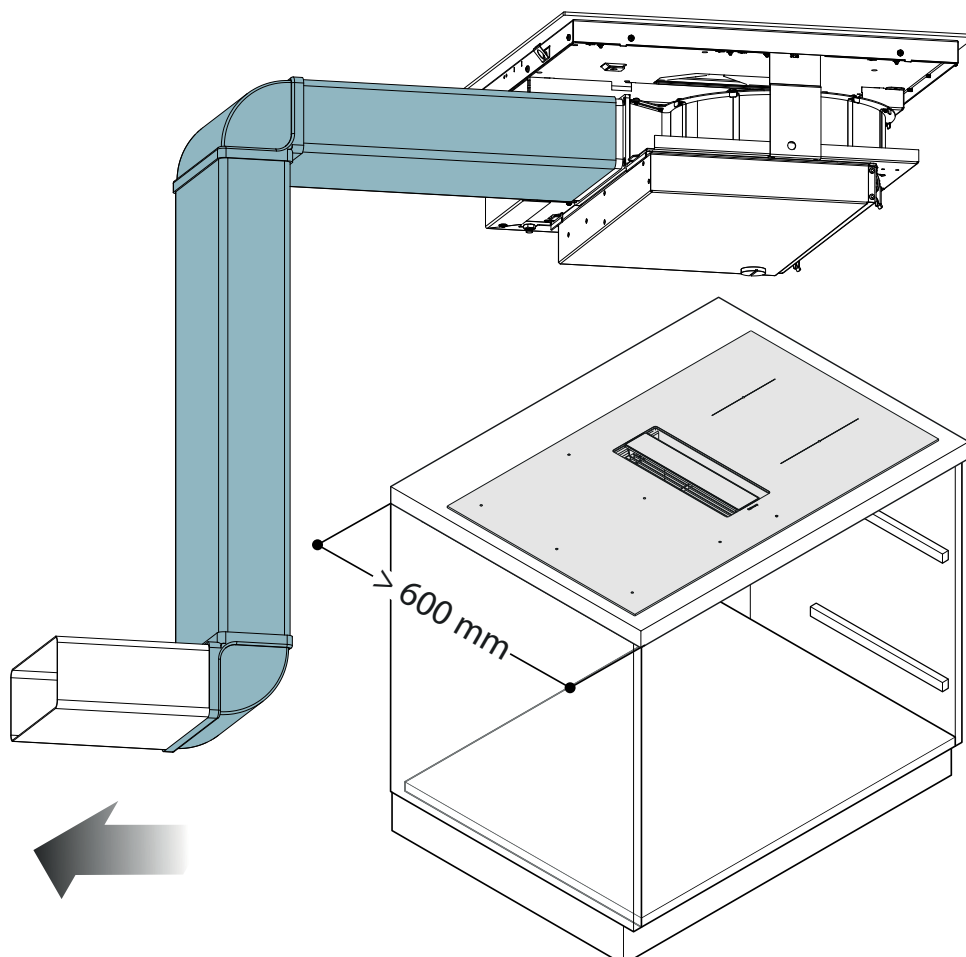
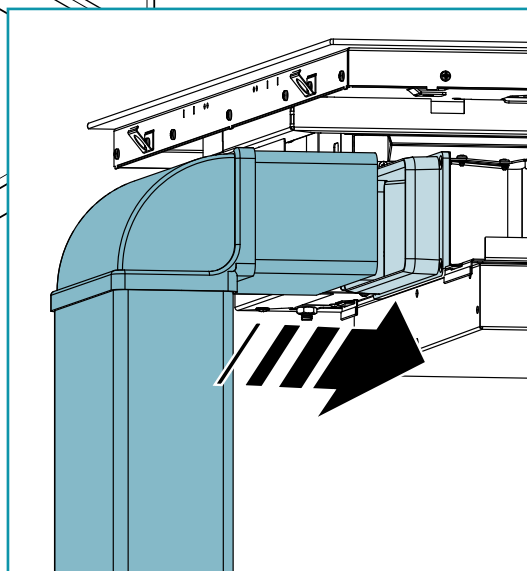
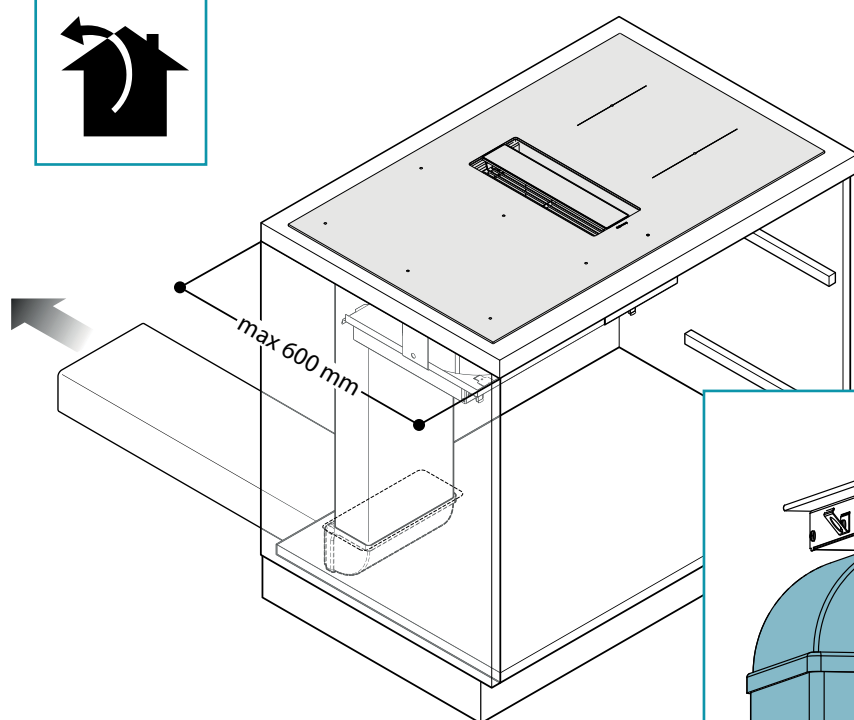



SAFETY INSTRUCTIONS AND WARNINGS



These warnings have been drawn up for your personal safety and those of others. You are therefore kindly asked to read the booklet carefully in its entirety before using or cleaning the equipment.

The Manufacturer declines all responsibility for any damage caused directly, or indirectly, to persons, things and pets as a consequence of failing to comply with the safety warnings indicated in this booklet.

It is imperative that this instructions booklet is kept together with the equipment for any future consultation.

If the equipment is sold or transferred to another person, make sure that the booklet is also supplied so that the new user can be made aware of the hood's operation and relative warnings.

Insist on original spare parts.



Intended use

- This cooker is intended to be used in domestic environments to prepare and keep dishes warm.
- Do not install the cooker outdoors and do not expose it to outdoor environment (rain, wind, etc.).
- Any other use is not admitted.
- The equipment can be used by children over the age of 8 and by persons with reduced physical, sensory and mental abilities, or with no experience or knowledge, as long as they do so under supervision or after having received relative instructions regarding safe use of the equipment and understanding of the dangers connected to it.
- Children are not to play with the equipment. Cleaning and maintenance by the user must not be carried out by children without supervision.
- Do not leave the cook top unmanned while it is working.

The equipment is solely intended to be used to extract fumes generated from cooking food in non-professional domestic kitchens: any other use is improper. Improper use can cause damage to persons, things, pets and exempts the Manufacturer from any liability.



Danger of burns

- Use the control lock to avoid that unauthorised people can switch on the appliance by themselves.
- place handles of frying pans and saucepans in a way that children cannot touch them.
- Switch off the cooking areas after use.
- Do not place any metal object on cooking areas that are on.



Technical safety

- **Installation operations are to be carried out by skilled and qualified installers in accordance with the instructions in this booklet and in compliance with the regulations in force.**
If the power cable or other components are damaged, the cook top shall NOT be used: disconnect the cooker from the power supply and contact the Dealer or an authorised Servicing Department for repairs.
Do not modify the electrical, mechanical or functional structure of the equipment.
Do not personally try to carry out repairs or replacements. Interventions carried out by incompetent and unauthorised persons can cause serious damage to the unit or physical and personal harm, not covered by the Manufacturer's warranty.
- **Before installing the cooker, check the integrity and function of each part. Should anomalies be noted, do not proceed with installation and contact the Dealer.**



The electrical system to which the device is to be connected must be in accordance with local standards and supplied with earthed connection in compliance with safety regulations in the country of use. It must also comply with European standards regarding radio anti-static properties.

The connection data (voltage and frequency) shown on the data plate of the cooker must match with those of the electric network.

Compare these data before connection.

In case of doubts, refer to an electrician.

- Do not use the cooker before installing it. It is forbidden to use the cooktop on moving equipment.
- Never open the case of the appliance.
- Falmec assures the compliance with the safety standards with original spare parts only.
- The appliance is not intended for use with external timer or remote control.

Before installing the hood, check that the electrical mains power supply corresponds with what is reported on the identification plate located inside the hood.

The socket used to connect the installed equipment to the electrical power supply must be within reach: otherwise, install a mains switch to disconnect the hood when required.

Any changes to the electrical system must be carried out by a qualified electrician.

Do not try to solve the problem yourself in the event of equipment malfunction, but contact the Dealer or an authorised Servicing Department for repairs.

 **When installing the device, disconnect the equipment by removing the plug or switching off the main switch.**

FUMES DISCHARGE SAFETY

 **Do not connect the equipment to discharge pipes of fumes produced from combustion (for example boilers, fireplaces, etc.).**

Before installing the hood, ensure that all standards in force regarding discharge of air out of the room have been complied with.

USE WARNINGS

-  • Before powering the appliance for the first time, remove any protective films and adhesives.
- While using, saucepans and kitchenware can cause noise that can depend on:
 - a high power level.
 - different materials of the bottom of saucepans.
 - Never use water to put fire out. Deactivate the cooking area. Choke flames with a cover, a fireproofing blanket or something similar to it.
 - Do not keep inflammable objects in the drawers below the cooker. The cutlery tray shall be made up of fire-resistant material.
 - Do not heat empty saucepans or frying pans and always check that saucepans have a minimum quantity of liquids inside.
 - Switch off the cooker after use.
 - Continuously check the cooking in case of greases and oils used, as they can easily catch fire.
 - Heat greases and oils at maximum for one minute and never use the Booster function.
 - Pay attention not to burn yourself during and after using the device.
 - Make sure that no fixed or mobile power cable of the device is in contact with the glass or a hot frying pan.
 - Do not use the cooker to heat pots.
 - Do not apply any type of cover on the cooktop.
 - Electrical cables are not to be in contact with the cooker.
 - It is recommended to protect hands from heat using pot holders. Only use dry gloves or pot holders.
 - Only use cookware with smooth and magnetic bottom suitable for induction hobs.
 - Avoid that sugar, synthetic materials of aluminium, films are in contact with the hot areas. During cooling, those substances can cause cracks or other alterations on the pyroceram surface: switch off the device and immediately remove from the cooking area that is still hot
 - When moving saucepans, make sure to lift them rather than slide them over the surface.
 - Saucepans and cooker are to be perfectly cleaned before being in contact.
 - Do not drop objects on the hob!



Only use saucepans with magnetic bottom. Other materials are not admitted.

SAUCEPAN SELECTION

Saucepans suitable for induction hobs:

Only saucepans with a fully magnetic, sufficiently wide and perfectly flat bottom are suitable for use on induction hobs.

The bottom is magnetic if a magnet sticks to every point on the bottom of the saucepan.

Using saucepans with uneven bottoms can make it difficult to detect the saucepan and heat it up.

Suitable saucepans (examples):

- Thick-bottomed enamelled steel saucepans
- Cast iron saucepans with enamelled bottom
- Multi-ply stainless steel saucepans
- Ferritic stainless steel saucepans



Saucepan bottom size:

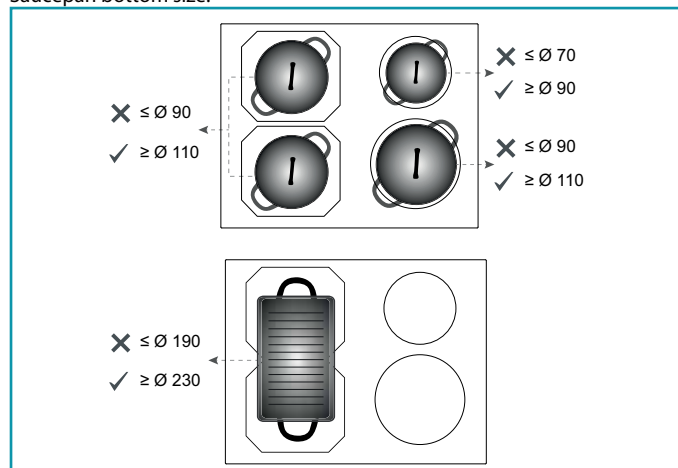

Saucepans not suitable for induction hobs:

Saucepans with non-magnetic or partially magnetic bottoms, with a size smaller than the indicated minimum and not perfectly flat are not suitable for use on induction hobs.

Unsuitable saucepans (examples):

- Copper saucepans
- Aluminium saucepans
- Ceramic saucepans
- Terracotta saucepans
- Stainless steel saucepans



Noise during cooking

Saucepans may generate noise during cooking: this is not a malfunction and does not affect the operation of the product.

The noise depends on the type of saucepan and the type of bottom;

If it is particularly unpleasant, it is recommended to replace the saucepan.

Humming, hissing, crackling sounds and vibrations are due to the transfer of energy to the bottom of the saucepan, and are generated by the various materials it is composed of. This noise is produced when cooking on a high power level and decreases as the set power level decreases.

Internal ventilation noise: the appliance is equipped with a ventilation module to adjust the internal temperature of the induction hob. Ventilation can remain on even after switching off the appliance.

- Use saucepans of appropriate size to the desired cooking area.
- Always use a saucepan or frying pan on each cooking area, even with the BRIDGE function.
- Do not place hot saucepans on the sensor keys or the LEDs, as this could cause damage to the electronic components underneath.
- Keep controls and lamps always clean.
- Do not keep metal objects directly below the cooker.
- Possibly use always covers to avoid heat dispersion.
- Cook with little water.
- After starting grilling or cooking dishes bring the power level to a lower one.

Safety and warning indications

Warning for people wearing pacemakers:

Keep in mind that when the appliance is being used an electromagnetic field forms in the immediate proximity. There is therefore a remote possibility that the operation of the pacemaker might be affected.

If in doubt, contact the pacemaker manufacturer or your GP.

The electromagnetic field of the hob during operation can affect the operation of magnetisable objects. Credit cards, life-saving devices, pocket calculators etc. should not be in the proximity of a hob when in operation.

Metal objects stored in the drawer underneath the appliance may become hot in case of prolonged use. Do not store metal objects in a drawer immediately underneath the hob.

The appliance is equipped with cooling fans. If there is a drawer under a built-in appliance, a separation must be ensured between the drawer and the bottom of the appliance, for appropriate hob ventilation and to make sure the fans are not be obstructed.

Never use two saucepans or pans on the same cooking zone, or a rectangular cooking zone, or a PowerFlex cooking area.



Before cleaning or carrying out maintenance operations, disconnect the equipment by removing the plug or switching off the main switch.

Do not use the hood with wet hands or bare feet.

Always check that all electrical parts (lights, extractor fan) are off when the equipment is not being used.



Do not rest objects on top of the motorised fins.

The maximum overall weight of any objects placed or hung (if applicable) on the hood must not exceed 1.5 Kg.

Always supervise the cooking process during the use of deep-fryers: Overheated oil can catch fire.

Never use the hood without the metal anti-grease filters: in this case, grease and dirt will deposit in the equipment and compromise its operation.

Accessible parts of the hood can be hot when used at the same time as the cooking appliances.

Do not carry out any cleaning operations when parts of the hood are still hot.

There can be a risk of fire if cleaning is not carried out according to the instructions and products indicated in this booklet.

Disconnect the main switch when the equipment is not used for long periods of time.



If other appliances that use gas or other fuels are being used at the same time (boiler, stove, fireplaces, etc.), make sure the room where the fumes are discharged is well-ventilated, in compliance with the local regulations.

INSTALLATION

only intended for qualified personnel



Before installing the hood, carefully read the chapter 'SAFETY INSTRUCTIONS AND WARNINGS'.

TECHNICAL FEATURES

The technical specifications are exhibited on the labels located inside the hood.

POSITIONING

Do not install the hood outdoors and do not expose it to outdoor environment (rain, wind, etc.).

COOKER

ELECTRICAL CONNECTION

(only intended for qualified personnel)



Disconnect the equipment from mains power network before carrying out any operation on the cooker.

Make sure that electric wires inside the cooker are not disconnected or cut:

in the event of damage, contact your nearest Servicing Department.

Refer to qualified personnel for electrical connections.

Connection must be carried out in compliance with the provisions of law in force.

Before connecting the cooker to the mains power network, check that:

- the mains voltage corresponds with the voltage indicated on the data plate located inside the cooker;
- the electrical system is compliant and can withstand the load (see the technical specifications located inside the cooker);
- the power supply plug and cable do not come into contact with temperatures exceeding 70 °C;
- the power supply system is effectively and properly connected to earth in compliance with regulations in force.
- the socket used to connect the cooker is within reach.

In case of:

- devices fitted with cables without a plug: the type of plug to use is a "standardised" one. The wires must be connected as follows: yellow-green for earthing, blue for neutral and brown for the phase. The plug must be connected to an adequate safety socket.
- fixed equipment not provided with a power supply cable and plug, or any other device that ensures disconnection from the electrical mains, with an opening gap of the contacts that enables total disconnection in overvoltage category III conditions.
- Said disconnection devices must be provided in the mains power supply in compliance with installation regulations.

The yellow/green earth cable must not be cut off by the switch.

The Manufacturer declines all responsibility for failure to comply with the safety regulations.

SAFETY DEVICES ON THE COOKER

Safety shutdown

If a cooking area exceeds the maximum time for operation at the same power, it is automatically switched off and the indication of the residual heat is shown.

To reset the cooking area, touch the necessary keys.

Power level	1	2	3	4	5	6	7	8	9	P
Maximum duration of operation in hours	6	6	5	5	4	1,5	1,5	1,5	1,5	5 min

The cooker switches off automatically if one or more controls stay covered for more than 10 seconds.

To restore the proper operation:

- remove all objects from the control panel.
- clean the control panel.
- restart the cooker and the concerned area.

Overheating device

Before items of the cooker can overheat, the control reduces the used power by following this procedure for protection measures:

- Deactivation of booster and power booster if turned on.
- Reduction of the power level set.
- Shutdown of the cooking area concerned.

On the display of the cooking area the message "E2" is displayed.

It is possible to restore the cooking area when the default message is off.

SAFETY INSTRUCTIONS FOR ASSEMBLY

Install the cooker after installing kitchen cabinets and basis.

Make sure that worktops have been veneered with thermoresistant glue in order not to suffer deflections or detachments.



It is forbidden to install the appliance on fridges or freezers, washing machines, dishwashers, or tumble driers.

Connection of the cooker

network	Connection	Cable section	Power cable	Switch gauge
220V - 240V~ 50/60Hz	1P+N / 2P	3 x 2.5 mm ²	H 05 VV - F H 05 RR - F	25 A *
380V - 415V~ 50/60Hz	2P+N	4 x 1.5 mm ²	H 05 VV - F H 05 RR - F	16 A *
380V - 415V~ 50/60Hz	3P+N	5 x 1.5 mm ²	H 05 VV - F H 05 RR - F	16 A *

* calculated with the contemporary factor in compliance with EN 60 335-2-6.

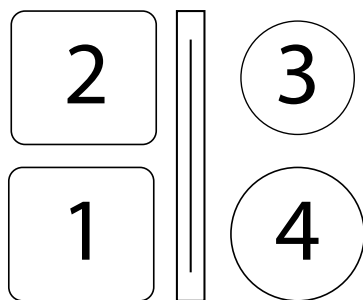

POWER:

Feature	
Total power	3000-7400W
Position 1	
Rated power	2100W
Booster power	3000W
Position 2	
Rated power	2100W
Booster power (1/2)	3000W
Position 3	
Rated power	1400W
Booster power (1/2)	2100W
Position 4	
Rated power	2300W
Booster power	3000W

PUSH-BUTTON PANEL

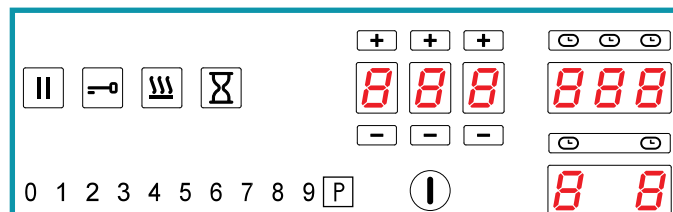

Control	description
	Cooker top ON/OFF. In case no other control is enabled, the cooker switches off automatically after a few seconds
	Pause key. It suspends cooking. See PAUSE function
	Control block key. Keyboard lock to prevent accidental controls
	KEEP WARM function key. Keeps cooking at a temperature of 44°C
	Timer key. Activates the setting of a generic timer
	Power level selector switch Sets the power of the selected cooking area on a scale of 0 to 9
	Booster key. Sets the power of the selected cooking area to the maximum available
	Timer area. Displays the set timer. The and keys increase or decrease the value shown on the corresponding display. The figures correspond from left to right: Hours, tens of minutes, minutes.
	Cooking area. Displays and selects the corresponding cooking area: - Front left - Rear left - Front right - Rear right
	Cooking area timer. Displays the activation of the timer linked to the corresponding cooking area

Display	description
	Cooking area in stand-by
	Selected cooking area
	Selected power level
	Power boost : maximum cooking power
	Residual heat indicator
	Keep warm function enabled
	Bridge function enabled

	Saucepan not present on the cooker top or not detected.
	Pause function enabled
	Child lock function enabled
	Automatic heating function enabled

OPERATION AND USE OF THE COOKTOP

ONLY USE COOKWARE SUITABLE FOR INDUCTION HOBS.

When a cooking area is turned on, the bottom of the saucepan heats. The cooking area only heats thanks to the heat given by the saucepan. The cooktop automatically detects the size of the saucepan. The heating power is to be chosen based on what shall be cooked. Please find below a short table:

SETTING AREAS

1 - 2	Melt Heat	Sauces, butter, chocolate, gelatine Precooked dishes
2 - 3	Whisk Defrost	Rice, pudding and cooked dishes Vegetables, fish, frozen food
3 - 4	Steam	Vegetables, fish, meat
4 - 5	Boil	Boiled potatoes, soups, pasta Fresh vegetables
6 - 7	Cook over a low heat	Meat, liver, eggs, sausages Goulash, rolate, tripe
7 - 8	Cook Fry	Potatoes, donuts, cakes
9	Fry, bring to the boil	Steaks, omelettes Boil
P	Fry, bring to the boil	Bring to the boil big quantities of water

Remark: heating time of cooktops is shorter than the gas cookers.

POWER CHANGE PROCEDURE

CAUTION: reducing power results in a limitation of the power levels that can be set in individual areas. These limitations are automatically managed by the device.

Sequence	description
	With the top switched off Press the ON/OFF key
	Within 3 seconds, press the ON/OFF key again. The key starts flashing
	Press and hold the pause key
	The cooking area displays show: Press the five areas clockwise.
	Release the pause key

Sequence	description
	The cooking area display shows the symbol alternating with the parameter number The Timer area displays the current setting of parameter The parameter for setting the power is U0.
	Press the Timer area to change the set power value. Press the power level selector: - left to decrease the value, - right to increase it
	Power Value Minimum: 1.4 2.8kW Maximum: 3.7 7.4kW Adjustment increment: 0.2kW
	Press to exit parameter setting
	To save changes and exit the menu: - press the ON/OFF key for 2 seconds. To exit the menu without saving changes: - press the key

AUTOMATIC SWITCH-ON OF THE COOKING AREA

- Turn on the cooker top
- Place the saucepan, not empty, on the cooking area

- The key corresponding to the area is automatically switched on
- The power level selector switch is activated by illuminating level 0

0 1 2 3 4 5 6 7 8 9

- Press the key of the cooking area to be set. The bottom right-hand dot

lights up

- Adjust the desired power level.

POWER LEVEL ADJUSTMENT:

- Slide your finger to the right in the power level selector switch and stop at the desired level.

0 1 2 3 4 5 6 7 8 9



- The display of the selected cooking area shows the set power level:

-->

- Press the **P** key to activate the booster level.

The display of the selected cooking area shows .
The booster level is maintained for a maximum of 5 minutes, after which the power level is raised to 9.

SWITCHING OFF THE COOKING AREA:

- Slide your finger to the left in the power level selector switch and stop at level 0.

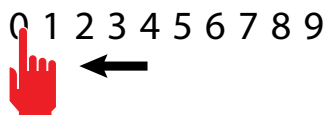

- The display of the selected cooking area shows the power level 0:



NOTE: all cooking areas can be switched off at the same time:
press key ① for 2 seconds..

On the display of the cooking areas that are still too hot, the symbol is



displayed. Do not touch the cooking areas as long as the lamp



is on.

BRIDGE FUNCTION:

- This function allows for the simultaneous operation of the cooking areas: 1-2 and/or 3-4; for the use of fish kettles or large rectangular saucepans.

NOTES: Automatic BRIDGE detection: the appliance automatically suggests the BRIDGE function if a sufficiently large saucepan is placed over cooking areas 1-2 or 3-4.



- Press the keys of the two cooking areas to be paired simultaneously.

CAUTION: only the indicated pairs can be coupled: front and back right area (1-2) or front and back left area (3-4).

- An acoustic signal warns of the activation of the function, the displays show:



- Adjust the desired power level.

To disable the BRIDGE function:

- Press the buttons of the two paired cooking zones at the same time.

KEEP WARM FUNCTION

keeps food warm at a temperature of around 44°C

- Press the key of the cooking area to be set.



The bottom right-hand dot lights up

- Press the Keep Warm key. - The cooking area display indicates the activation of the function



To deactivate the KEEP WARM function:

- Press the cooking area key with the Keep Warm function active



- Press the Keep Warm key.

PAUSE FUNCTION

suspends the operation of all cooking areas.

- Press the pause key
- The cooking area displays indicate the activation of the pause function

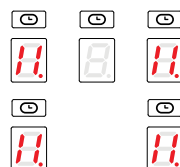

The Pause function can only be activated for 10 minutes, after which the device switches off.

To deactivate the PAUSE function:

- Press the pause key. The key starts flashing
- Press any key except the Pause key.
- The function is disabled and the cooking areas will resume operation prior to activation of the Pause function.

NOTE: Interruption and restoration of the power supply deactivates the PAUSE function.

CONTROL BLOCK FUNCTION:

disables all device keys to prevent accidental activation when cleaning the cooker top.

- Press the Control block key for 1 second

All keys except the Control block and ON/OFF keys are disabled.

To deactivate the CONTROL BLOCK function:

- Press the Control block key for 1 second

CHILD LOCK FUNCTION:

deactivates operation of all keys

- **IMPORTANT:** perform the entire procedure within 10 seconds



- Press a cooking area key for 3 seconds
- Release the key and slide your finger to the right in the power level selector switch from 0 to 9

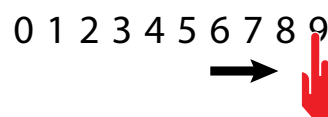

- The cooking area display indicates the activation of the function



To deactivate the CHILD LOCK function:

- **IMPORTANT:** perform the entire procedure within 10 seconds



- Press a cooking area key for 3 seconds
- Release the key and slide your finger to the left in the power level selector switch from 9 to 0

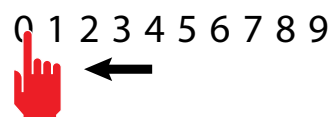

TIMER FUNCTION

allows you to set a time after which an acoustic alarm will sound.

- Press the Timer key

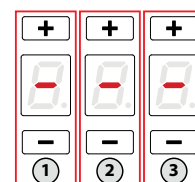

- The Timer area is activated:

- Press the + and - keys to set the timer.

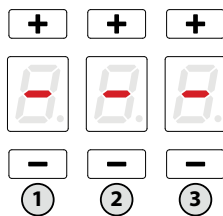

Area 1: hours

Area 2: tens of minutes

Area 3: minutes

Maximum setting time: 9 hours 59 minutes

- After 10 seconds the timer will start the countdown.

- At the end of the countdown, an acoustic signal will sound.

- Press any key to deactivate the acoustic signal.

COOKING AREA TIMER FUNCTION:

allows a cooking area to be switched off after a set time

- Press the key of the cooking area to be set. The bottom right-hand dot



lights up

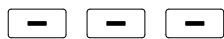
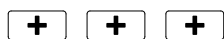

- Press on the Timer area.

- The timer area is activated:

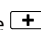

and the symbol  above the cooking area

flashes.

- Press the  and  keys to set the timer.

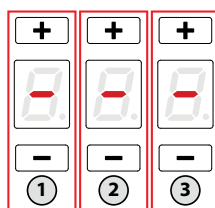

Area 1: hours

Area 2: tens of minutes

Area 3: minutes

Maximum setting time: 9 hours 59 minutes

- After 5 seconds the timer will start the countdown.

- At the end of the countdown, the relevant cooking area will be switched off and an acoustic signal will sound.

- Press any key to deactivate the acoustic signal.

AUTOMATIC HEATING FUNCTION:

sets the maximum power for a preset time and returns to the previous power level.

- Press the key of the cooking area to be set. The bottom right-hand dot



lights up

- Slide your finger to the right in the power level selector switch and stop at the desired level. The function can only be activated for levels 1 to 8.

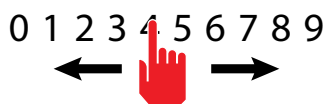

- Press and hold the selected level for 3 seconds

3 sec



- The cooking area display indicates the activation of the function



Function duration table:

Power level	Automatic heating function time (seconds)
1	48
2	144
3	230
4	312
5	408
6	120
7	168
8	210
9	Function not available
P	Function not available

- When the time elapses, the function ends and the cooking area is reset to the previously set power level.

To deactivate the AUTOMATIC HEATING function:

1 - Wait for the end of the function time

or



2 - Press the cooking area key for 3 seconds

- the function ends and the cooking area is reset to the previously set power level.

or

3 - If a lower power level is set than before the automatic heating function, the function is deactivated.

RECALL FUNCTION:

enables the recovery of cooking settings prior to an accidental cooker top switch-off.

- Perform the following steps within 6 seconds of an accidental switch-off

- Turn on the cooker top 

- The pause key  flashes

- Press the pause key 

The RECALL function resets the operation of the cooking areas, timer functions and quick heating. Other functions will not be restored.

WHAT TO DO IN CASE OF COOKERS PROBLEMS

The cooker or cooking areas do not turn on:

- The cooker is not connected to the electric network.
- The protection fuse is released.
- Check if the block is not active.
- Keys are covered with water or grease.
- An object is placed on the keys.

The symbol is displayed .

- There is no saucepan on the cooking area.
- The container used is not compatible with cooktops.
- The diameter of the saucepan bottom is too small compared to the cooking area.

The symbol [E] is displayed:

- Disconnect and connect the cooker.
- Contact the after-sales centre.

One of the area or the entire cooker turns off:







- The safety overheating system is active;
- The cooker or one cooking area remains on for too long;
- one or more keys are covered;
- one of the saucepans is empty and the bottom overheated.

The fan keeps on working after the cooker shutdown:

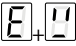
- This is not a malfunction: the fan keeps on protecting the electronic power unit of the device.
- The fan stops automatically.

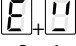
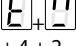
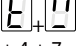
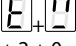
COOKERS ERROR CODES

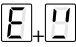
In case of error, the device displays error codes for support purposes. The display of the cooking area shows the error code alternating 'E' with other symbols and numbers.

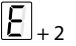
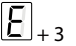
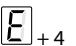
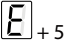
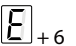
Error code	Description	Possible causes	Solution
 + 0 + 3	Continuous activation of a key	- Metal objects above the keyboard - water over the keyboard	- Move the metal objects - Dry the water
 + 2 + 1	Internal temperature above 85°C	- covered or insufficient ventilation areas	- Allow internal heat dissipation
 + 3 + 1	Incorrect configuration	- configuration error	- Contact Technical Support
 + 4 + 2	Internal supply voltages too high or low	Overcharging due to atmospheric discharge, electrical system failure or incorrect power connection	- Contact Technical Support
 + 4 + 7	No communication between keyboard and inductor modules	- Communication cable damaged or disconnected - Damaged inductor module	- Contact Technical Support
 + 2 + 0  + 2 + 2  + 3 + 5  + 3 + 6	Control keyboard internal error		- Contact Technical Support
 + 2	Temperature limits were exceeded in the cooking area	- Empty saucepan - unsuitable saucepan type - saucepan or glass too hot	- fill the saucepan - use a suitable saucepan - remove the saucepan and allow the area to cool down
 + 3	Unsuitable saucepan	- The saucepan has little ferritic material - The saucepan caused an error in the inductor module - Inductor failure	- Use a suitable saucepan - Remove the saucepan, wait 8 seconds and try again - Contact Technical Support
 + 4	Incorrect configuration	- inductor configuration error	- Contact Technical Support
 + 5	No communication between keyboard and generator	- Faulty or disconnected LIN cable - Incorrect electrical connection - Internal fault - Configuration error	- Contact Technical Support - Check terminal board electrical connection - Contact Technical Support - Contact Technical Support
 + 6	Incorrect power supply	- Out-of-range supply voltage - Incorrect supply voltage frequency - Inductor failure	- Check that the supply voltage is correct: voltage and frequency. - Contact Technical Support

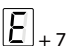
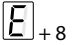
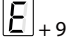
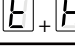
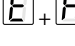
 + 7	Internal inductor failure		- Contact Technical Support
 + 8	Cooling fan not working	- Dirty fan - Fan Failure	- Clean the air vents - Contact Technical Support
 + 9	Faulty inductor temperature probe	- Faulty inductor temperature probe	- Contact Technical Support
 + A	Internal inductor failure		- Contact Technical Support
 + H	Inductor temperature probe has a fixed value	- glass too hot - faulty probe	- Cool the glass - Contact Technical Support

Note:

Not each failure can be detected automatically by the system, e.g. in case of defect of the User interface power supply.

Note:

Not each failure can be detected automatically by the system, e.g. in case of defect of the User interface power supply.

COOKER HOOD

FUMES DISCHARGE

EXTERNAL EXHAUST HOOD (SUCTION)

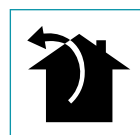

In this version the fumes and vapours are discharged outside through the exhaust pipe. To this end, the hood outlet fitting must be connected via a pipe, to an external output.

The outlet pipe must have:

- a diameter not less than that of the hood fitting.
- a slight slope downwards (drop) in the horizontal sections to prevent condensation from flowing back into the motor.
- the minimum required number of bends.
- the minimum required length to avoid vibrations and reduce the suction performance of the hood.
- You are required to insulate the pipes if it passes through cold environments.
- In the presence of motors with 800m³/h or higher, a check valve is present to prevent external air flowing back.

Deviation for Germany:

when the kitchen hood is used at the same time as appliances that are powered by energy other than electricity, the negative pressure in the room must not exceed 4 Pa (4 x 10-5 bar).

HOOD WITH INTERNAL RECIRCULATION (FILTERING)



In this model, the air passes through the **Carbon-Zeo** (optional) filters to be purified and recycled in the environment.

Ensure that the **Carbon-Zeo** filters are assembled into the hood, if not, install them as indicated in the assembly instructions.

ASSEMBLY INSTRUCTIONS

only intended for qualified personnel



The hood can be installed in various configurations. The generic assembly steps apply to all installations; for each case, follow the specific steps provided for the required installation.

OPERATION

WHEN TO TURN ON THE HOOD?

Switch on the hood at least one minute before starting to cook to direct fumes and vapours towards the suction surface.

After cooking, leave the hood operating until complete extraction of all vapours and odours. By means of the Timer function, it is possible to set auto switch-off function which will allow the hood to turn off automatically after 15 minutes of operation.

WHICH SPEED IS TO BE SELECTED?

speed (1-3): maintains the circulation of clean air with low electricity consumption.

speed (4-5): normal conditions of use.

speed (6-7): presence of strong odours and vapours.

speed (8-P): rapid disposal of odours and vapours.

WHEN SHOULD THE FILTERS BE WASHED OR REPLACED?

The metal filters must be cleaned every 30 hours of operation.

The active carbon filters must be replaced every 18 months and replaced every 3 years.

For further details see the "MAINTENANCE" chap.

HOOD TOUCH PUSHBUTTON PANEL

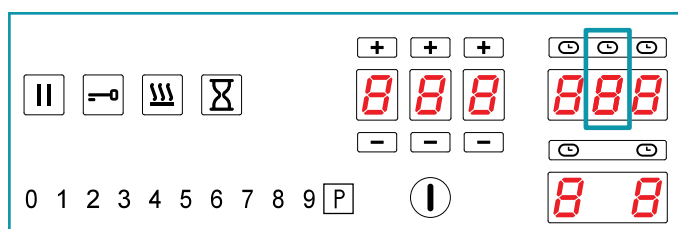

	<p>Speed increase from 1 to...9 (up to "P"). Speed "P": active only for a few minutes, then speed 9.</p>
	<p>A: Hood operation automatic cycle activation (A) according to plate power.</p>
	<p>Hood timer function. Allows you to turn off the hood after a set time</p>
	<p>Automatic switch off: if all the burners are turned off, the hood stays on for 5 minutes and then turns off automatically</p>
	<p>Carbon.Zeo filter alarm: Maintenance after about 1500 hours of use. The display shows "F".</p> <p>To reset the alarm: press the key for 5 seconds</p> <p>To Activate the alarm: With the hood off, press the hood display for 5 seconds. The activation of the Carbon.Zeo filter alarm function is given by the visualization of F + A on the display</p> <p>To turn off the alarm: With the hood off, press the hood display for 5 seconds. The deactivation of the Carbon.Zeo filter alarm function is given by the visualization of only F on the display</p>



If the pushbutton panel is completely inactive, before contacting the Technical assistance service, disconnect power temporarily to the appliance (about 5"), possibly by acting on the main switch, to restore normal operation. If this measure has no effect, contact the Technical assistance service.

CLEANING AND MAINTENANCE



ATTENTION!

For cleaning, never use a steam equipment.

Before cleaning the cooker, make sure that it is at room temperature.

Always clean the cooker after each use with a specific cleanser for pyroceram.

Do not use products containing:

- corrosive agents (soda, acids, ammoniac).

- abrasive agents (dusts or paste).



Do not wash the flaps in a dishwasher.

Do not use pointed or abrasive objects.

After cleaning, dry the appliance with a soft cloth.

USEFUL CARE TIPS

Clean your glassceramic cooktop regularly, preferably every time you use it. Avoid using abrasive sponges or scouring agents.

Harsh chemical cleaners like oven sprays or stain removers are also unsuitable, as are bathroom or household cleaners.

Accidents happen ...

Do not allow the hot hob to come into contact with plastic, tin foil, sugar or sugary food have fallen on the hot glass-ceramic cooktop. Please scrape it off the hot surface as quickly as possible. If these substances melt, they can damage the glass-ceramic cooktop.

Sparkling results in only three steps:

To thoroughly clean your glass-ceramic cooktop, first remove dirt and food with a suitable metal scraper.

Once the glass-ceramic cooktop has cooled, put a few drops of a suitable cleaner on it and rub it on with a paper towel or a clean cloth.

Then wipe the glass-ceramic cooktop with a damp cloth and dry it with a clean cloth.

How do I identify a suitable glass-ceramic scraper?

- Scraper made of metal (won't melt or catch fire)
- Scraper easy to lock / to unlock
- Blade is fixed precisely, it does not shift
- Blade is unbroken, clean and stainless
- Scraper certified by testing institute, if procurable (e.g. TÜV-GS seal)
- User manual and safety instructions available

CLEANING OF INTERNAL SURFACES



Do not clean electrical parts, or parts related to the motor inside the hood, with liquids or solvents.

For the internal metal parts, see the previous paragraph.

METAL ANTI-GREASE FILTERS

It is advised to **frequently** wash the metal filters (F) (at least once a month) leaving them to soak in boiling water and cleaning solution for 1 hour, taking care not to bend them.

Do not use corrosive, acid or alkaline detergents.

Rinse them well and wait for them to be completely dry before reassembling them.

Washing in a dishwasher is permitted.

To extract and insert the metal anti-grease filters see the assembly instructions.

CARBON-ZEO FILTERS

Under normal conditions, they should be regenerated every 18 months and replaced after 3 years. To regenerate the filter, follow the following procedure:

- Remove the filter as described in the instructions.
- Insert filters A, B and C (if any) in a domestic oven at 200°C for about 2 hours.
- When the filter has cooled down, refit the 4 filters onto the metal structure of the filter.

GREASE DRIP TRAY

It is advisable to clean the tray every 1 month.

Do not use corrosive, acid or alkaline detergents.

For more thorough cleaning, remove the oil collection tray (see figure) and wash it with water and washing up liquid. Rinse it well and wait for it to be completely dry before reassembling it.

DISPOSAL AFTER END OF USEFUL LIFE



The crossed-out wheeled bin symbol on the appliance means that **the product is WEEE**, i.e. "Waste electrical and electronic equipment", accordingly **it must not be disposed of with unsorted waste** (i.e. with "mixed household waste"), but it must be disposed of separately so that it can undergo specific operations for its re-use, or a specific treatment, to remove and safely dispose of any substances that may be harmful to the environment and remove the raw materials that can be recycled. Proper disposal of these products contributes to saving valuable resources and avoid potential negative effects on personal health and the environment, which may be caused by inappropriate disposal of waste.

You are kindly asked to contact your local authorities for further information regarding the designated waste collection points nearest to you. Penalties for improper disposal of such waste can be applied in compliance with national regulations.

INFORMATION ON DISPOSAL IN EUROPEAN UNION COUNTRIES

The EU WEEE Directive was implemented differently in each country, accordingly, if you wish to dispose of this appliance we suggest contacting your local authorities or dealer to find out what the correct method of disposal is.

INFORMATION ON DISPOSAL IN NON-EUROPEAN UNION COUNTRIES

The crossed-out trash or refuse bin symbol is only valid in the European Union: if you wish to dispose of this appliance in other countries, we suggest contacting your local authorities or dealer to find out what the correct method of disposal is.



WARNING!

The Manufacturer reserves the right to make changes to the equipment at any time and without prior notice. Printing, translation and reproduction, even partial, of this manual are bound by the Manufacturer's authorisation.

Technical information, graphic representations and specifications in this manual are for information purposes and cannot be divulged.

This manual is written in Italian. The Manufacturer is not responsible for any transcription or translation errors.

Falmec S.p.A

**via dell'Artigianato, 42 z.i.
31029 Vittorio Veneto
Treviso — Italy
info@falmec.com
falmec.com**

**Codice / Code / Code / Code / Código /
Matricola / Serial number / Seriennummer / Numéro de série / Matricula**

┌

┐

└

┘